



# ***Instruction Manual***

MANTR13-B REV A 19/04/21

**RECHARGEABLE TROLLEY SPRAYER 13L  
TR13-B**



**SILVAN AUSTRALIA PTY. LTD.**

ABN 48 099 851 144

**SILVAN SERVICE SUPPORT PH 1300 745 826 (AUST) OR 0508 745 826 (N.Z)**  
email: [info@silvanaust.com](mailto:info@silvanaust.com)

***VICTORIA (HEAD OFFICE)***

Telephone: +61 (03) 9215 2700

Fax: +61 (03) 9215 2701

[www.silvan.com.au](http://www.silvan.com.au)

***NEW ZEALAND***

Hamilton, New Zealand

Telephone: +64 (07) 8496 033

Fax: +64 (07) 8496070 2701

[www.silvannz.co.nz](http://www.silvannz.co.nz)



Before attempting to operate or install the sprayer carefully read and take note of the following safety warnings.

Failure to comply with these warnings may result in serious injury or death.

- This sprayer is designed and manufactured solely for the purpose of applying agricultural chemicals. Under no circumstances may it be used for any other purpose.
- Read owner's manual completely before operating this sprayer.
- Test the sprayer with water before using chemicals
- Before using chemicals refer to the chemical manufacturer's label and safety instructions for safe handling procedures and recommended personal protective clothing and safety equipment.
- Never use flammable liquids, caustics, acids, or hot water in this tank.
- Do not use sprayer near open flame or anything that could cause ignition of the spray.
- Do not leave sprayer in the sun when not in use.
- Spray when the air is calm to prevent drift of chemicals. Do not spray in windy conditions.
- Always inspect hose and all the hose connections before each use. A damaged hose, or loose hose connection can result in unintended exposure to the pressurised chemical, resulting in serious injury or property damage.
- Do not lift or carry sprayer by the hose, shut-off valve, or wand extension. Carry by the handle only.
- Do not pressurise with any mechanical device such as an air compressor as this can create a dangerous pressure level resulting in explosion and serious injury. Only use original pump.
- Do not store chemicals in this tank.
- Dispose of empty chemical containers and chemical residues in accordance with the instructions supplied by the chemical manufacturer.
- Always release pressure when sprayer is not in use and before performing any maintenance.
- Clean and rinse sprayer thoroughly after each use and before and maintenance.
- Never attempt to alter sprayer from original condition.
- Exercise care to ensure proper stability when carrying or operating in hilly or uneven terrain, particularly if the ground is wet or loose. Wear non-slip shoes
- Keep the sprayer and all chemicals out of the reach of children.

## BATTERY CHARGER WARNINGS

- When using the battery charger ensure it is a dry environment and do not leave the charger where it may rain.
- The battery charger is not to be used by persons (including children) with reduced physical, sensory, or mental capabilities, or lack of experience and knowledge, unless they have given supervision or instruction.
- Children should be supervised not to play with the battery charger.
- Do not use this charger to charge Non-Rechargeable battery packs.
- If the supply cord is damaged, it must be replaced by the manufacturer, its service agent, or similarly qualified persons to avoid a hazard.

**GENERAL:**

This trolley sprayer has been designed and manufactured primarily for applying agricultural and horticultural herbicides and insecticides to plants. It may also be used for cleaners and other products not compatible with Viton seals.

**TANK:**

13L blow moulded translucent polyethylene tank, U.V. stabilised and impact resistant with calibrated fill mark moulded into the tank. Safety pressure release valve fitted. Nominal capacity 13 Litres.

**PUMP:**

Rechargeable Battery operated air pump. Max 1.8Bar Pressure. 3 Tank fills between recharges.

**BATTERY:**

2550mAh Capacity Li Ion

**BATTERY CHARGER:**

Input 100 – 240V, 50/60Hz, 0.4A Max

Output 9V, 1A

Model FJ-SW126K0901000DS (Silvan P/No TR13-26)

Only available from Silvan and Only for charging Silvan Trolley Sprayer Part No TR13-B

**SPRAY LANCE:**

Trigger jet assembly with 780mm long telescopic lance extendable to 1150 mm supplied with adjustable nozzle

**TROLLEY:**

2-wheel Trolley, Adjustable handle length, 150mm diameter wheels

**FILTRATION:**

Filter in spray lance handle.

**DIMENSIONS:**

Length: 260 mm

Width: 330 mm

Height: 850 mm

Weight (dry): 3.9 kg

## **GUN ASSEMBLY:**

Fit the spray lance to the gun ensuring the rubber seal is fitted. Fit the 45-degree elbow and nozzle to the tip of the lance again ensuring the seals are in place.

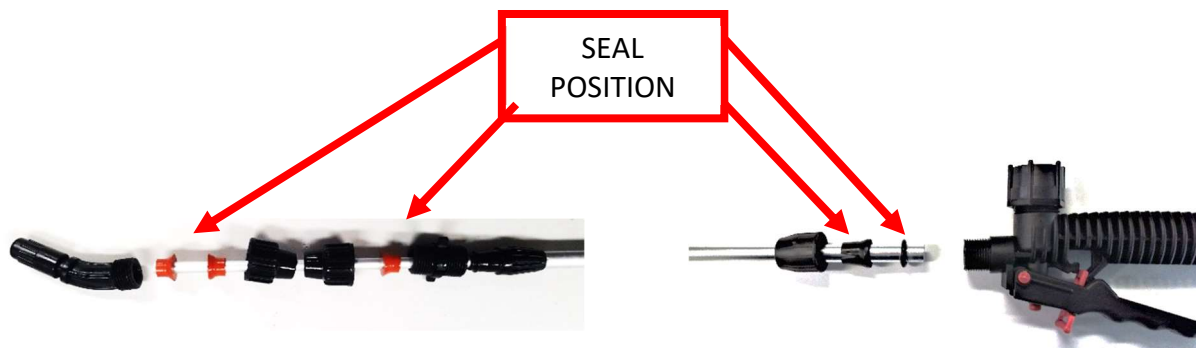

## **FIT THE TROLLEY HANDLES AND ADJUST THE HEIGHT:**

The handle length can be adjusted by loosening the nut shown in the diagram, adjusting the length and retightening.



## **CHARGING THE PUMP:**

Ensure the pump and charger are placed in a clean dry location where they will not be exposed to liquids, falls, or high temperatures

Insert the charger into the electrical wall socket

On the end of the pump handle remove the rubber cover and plug the charger cable plug into the socket in the pump



Charging time is approximately 3 hours

The pump has an indicator light next to the on/off button. The light indicates the following

## **PUMP LIGHT INDICATOR SIGNALS WHEN CHARGING**

The pump cannot be operated while charging. The pump must be disconnected from the charger.

*Flashes Green* -The light on the pump will flash green when the battery is charging

*Solid Green* – The light remains green and does not flash when the battery is fully charged. Charging time is approximately 3 hours

*Flashing Red Light* -If the light on the pump flashes red when the charger is connected, then the battery is too hot to be safely charged. If this happen the battery must be allowed to cool down before charging. This can happen if the battery has been used continuously for a long time or has been left in the sun or a hot place such as car during hot weather.

## **PUMP LIGHT INDICATOR WHEN PUMP OPERATING**

*Solid Green* – When the pump is switched on and the battery is fully charged the green light on the pump will stay on continuously. The green light will also remain on if the pump has reached its maximum pressure and the pump has stopped pumping

*Flashing Green* -The light on the pump will flash green when the batteries are almost discharged and require recharging. This occurs about ½ a tank before the batteries become completely flat and require recharging. When the batteries go completely flat the pump shuts off and the light goes out.

When charging is complete the green light stays on continuously.

The pump should not remain connected to the charger during long periods of storage.

To ensure optimal battery life the pump should be charged at least once every 6 months

## **FILLING THE TANK AND ADDING CHEMICAL:**

**Warning:** Before using the sprayer for the first time or adding chemical check the operation and function of the sprayer with clean water.

Check that the filter is clean, and all fittings, hoses and gun connections are tight.

Partly fill the sprayer before adding chemical. Always use clean water to prevent blockages and ensure chemical function is not inhibited.

Add the chemical according to the directions on the chemical container following all safety and protective equipment recommendations.

Do not use wet powders or chemicals that must remain suspended in solution and require agitation. Only use chemicals or dyes that fully dissolve.

Do not use a sprayer that has been used to spray herbicides to then spray insecticides or nutrients unless the sprayer has been thoroughly cleaned, including neutralising the herbicide according to the manufactured directions if required.

## **OPERATING THE PUMP:**

Press the power button to turn the pump on to begin pressurising the tank. The pump will automatically switch off when the maximum pressure is reached. Once you commence spraying the pressure in the tank begins to reduce and the pump will then automatically switch on again. Refer also to the *Pump Light Indicator Signals* section of this manual.

## **ADJUSTING THE SPRAY LANCE AND THE NOZZLE:**

The spray lance can be adjusted by loosening the nut as shown below, extending the lance to the desired length, and retightening. The nozzle can be adjusted by loosening the nozzle as shown below to obtain the desired spray stream (single stream or cone stream).

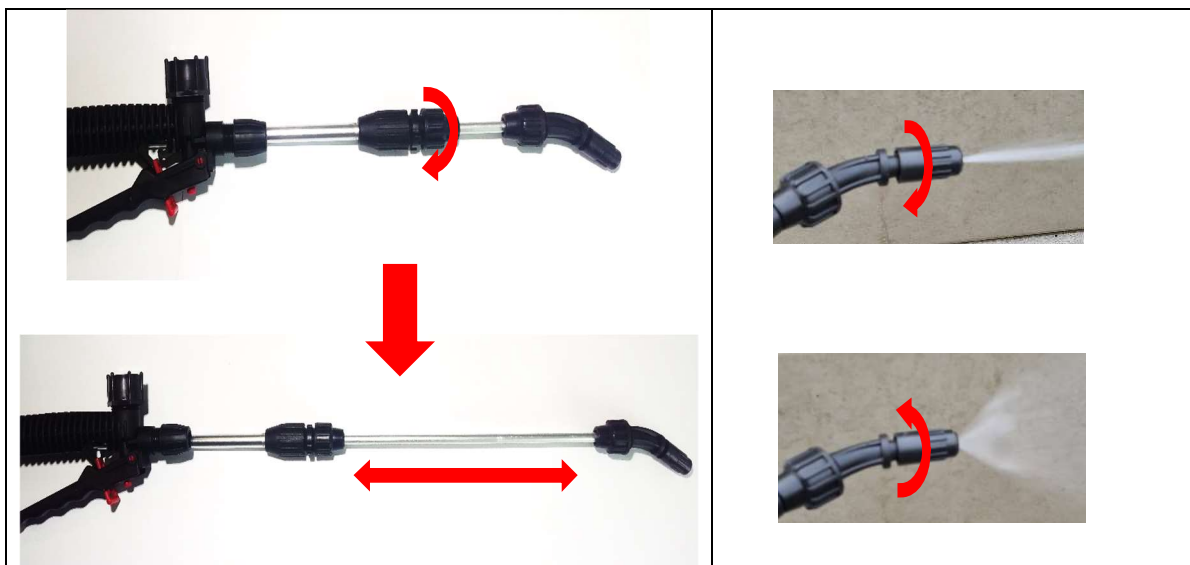

## Service & Maintenance

---

### CLEANING THE FILTER IN THE GUN HANDLE:

Use clean water and rinse out the sprayer after use to avoid the filter becoming clogged. The filter is fitted inside the handle of the sprayer. Unscrew the hose connection to the gun and withdraw the filter. The Filter may be either Type A or alternative Type B. Type B must be removed with pointy nose pliers.

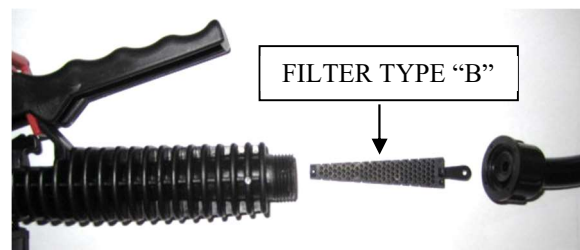
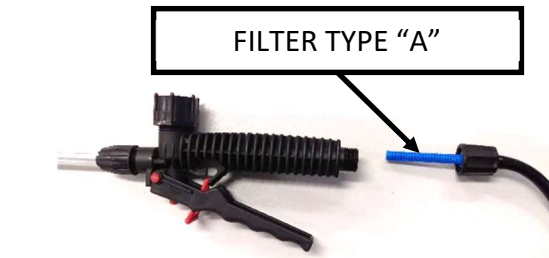

### SERVICING THE SUCTION HOSE:

Inspect the pipe that attaches to the hose, check that it is still attached.



TROUBLESHOOTING GUIDE	
Problem	Solution
No or limited pressure inside the tank.	<ul style="list-style-type: none"> <li>Air Leak:                             <ul style="list-style-type: none"> <li>Check pump assembly is screwed in tight. Check for dirt or damage of sealing gasket, replace if necessary.</li> <li>Check safety air release valve is tightly fitted, not damaged or making “hiss” noise. Remove, clean then refit.</li> <li>Check Spray hose connection, where hose exits tank is tightly fitted and connection not making “hiss” noise</li> </ul> </li> <li>Pump will not run:                             <ul style="list-style-type: none"> <li>Check the <i>Charging the pump section of this manual</i></li> </ul> </li> </ul>
There is pressure inside tank but limited or no flow from the nozzle	<ul style="list-style-type: none"> <li>Unscrew the spray gun from the hose to access the filter inside the gun handle to clean.</li> <li>The nozzle is blocked. Unscrew the black coloured nozzle from the end of the gun and clean all parts.</li> </ul>
The sprayer sprays air without water	<ul style="list-style-type: none"> <li>The suction tube inside the tank has become loose. Refit.</li> </ul>
Lance filter blocked	<ul style="list-style-type: none"> <li>Clean filter with water only</li> </ul>



N.	Code	Description	Qty
1	TR13-27	PUMP RECHARGEABLE SUIT TR13-B	1,00
2	TR13-26	BATTERY CHARGER SUIT TR13-B	1,00
3	TR13-24	SAFETY VALVE SUIT TR13-1	1,00
4	382-097	EXTENDABLE LANCE ONLY SUIT SP55-BU	1,00
5	TR13-23	HANDLE LOCK NUT SUIT TR13-1	1,00
6	TR13-25	O-RING BETWEEN PUMP AND TANK SUIT TR13- 1 TR13-B	1,00