

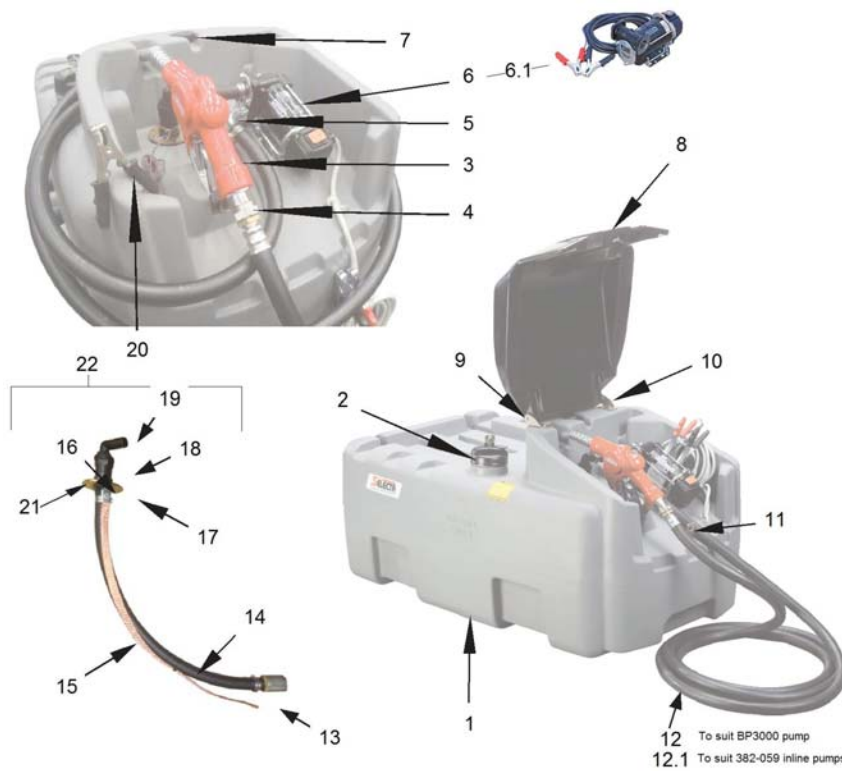









200L DIESELPRO



**DIESEL PRO
200 LITRE**

Part No.
SQDN200L-X1



		Code	Description	Qty Note	EAN CODE
1		430-200H	TANK 200L DIESELPRO	1,00	9327602146112
2		06792504	LID LOCKABLE MALE D103MM	1,00	9327602300521
3		PF01	AUTOMATIC DIESEL GUN	0,00	9327602019218
4		PF01-SW	SWIVEL SUIT PF01 3/4MF	0,00	9327602174443
5		F16173000	CURVED 19mm TAIL BP3000	1,00	9327602309821

6		F00342030	BP3000 BARE PUMP	1,00	000000330756
6.1		382-059	PUMP 12V PUISI BP3000 INLINE	1,00	ONLY USED ON THE LATER MODELS SQDN200L-Z1 9337027042517
7		G8208000	VALVE BREATHER SGL LOCKNUT	1,00	9327602040366
8		425-112	COVER DIESEL PRO.	0,00	000000332705
9		454-297	BKT-HINGE LHS DIESELPRO COVER	0,00	000000332675
10		454-298	BKT-HINGE RHS DIESELPRO COVER	0,00	000000332668
11		454-299	BKT-LATCH DIESELPRO COVER	0,00	000000332651
12		F1667000	HOSE 5M W/3/4 BP3000 HOSETAIL	5,00	000000330763
12.1		382-093	DIESEL HOSE 5M 3/4BSPM - 3/4BSPM	1,00	USED ON LATER MODELS SQDN200L-Z1, DIFFERNT HOSE ENDS FOR Z1 MODEL 9327602325883
13		PF0225-23	FILTER SUCTION SS	1,00	9327602027053
14		PF0225-33	HOSE-3/4in EXTRA DIESEL	800,00	9327602029385
15		ASPAKLOOM4	EARTHING STRAP INTERNAL	1,00	000000322041
16		G8001203	ADAPT HSE 3/4inBSPMX19MM Tin	1,00	9327602026087
17		454-292	GASKET NITRILE DIESEL SUCTION	0,00	000000331364
18		2302030	SOCKET 3/4in FEMALE	0,00	9327602161214
19		1132320	ELBOW 3/4IN BSPMX19MM TAIL	0,00	9327602126244
20		ASPAKLOOM5	EARTHING LEAD EXTERNAL	1,00	000000322034
21		454-294	DIESEL 3/4inFITTING PLATE	1,00	000000331388
22		ASHOSESQDL-1	ASSY SUCTION HOSE SQDN200L-X1 SQDN400L-X1	1,00	COMPLETE HOSE ASSY 000000339377